



## INSTALLATION INSTRUCTIONS FOR PART 95-6511-17

### APPLICATIONS

#### Chrysler

Aspen 2008-09/Sebring 2007-09  
Town and Country 2008-09/300/300c 2008-09

#### Dodge

Avenger 2007-09/Caliber 2009/Challenger 2009  
Charger 2008-09/Dakota 2008-09/Durango 2008-09  
Grand Caravan 2008-09/Journey 2009\*  
Magnum 2008/ Nitro 2007-09/Ram 1500 2009

#### Jeep

Compass 2009/Commander 2008-09/Grand Cherokee 2008-09/Patriot 2009  
Liberty 2008-09/Wrangler 2007-09\*

*\*(Modifications to radio cavity required)*

#### Mitsubishi

Raider 2008

# 95-6511-17

### KIT FEATURES

- Double DIN Radio Provision
- Stacked ISO Units Provision

### KIT COMPONENTS

A) Double DIN Brackets/Trim Plate

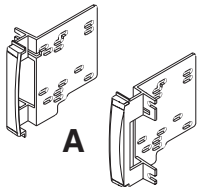

### WIRING AND ANTENNA CONNECTIONS (Sold Separately)

#### Harness:

- XSVI-6522-NAV - Chrysler CAN rap harness 07-up
- CHT0-03 - Chrysler CAN amp harness 07-up

#### Antenna Adapter:

- 40-EU10 - European antenna adapter 02-up

### TOOLS REQUIRED:

Small Flat Blade Screwdriver/ Panel Removal Tool

- Phillips Screwdriver • Socket Set



1-800-221-0932



www.metraonline.com

© COPYRIGHT 2017 METRA ELECTRONICS CORPORATION

## TABLE OF CONTENTS

### Dash Disassembly

- Chrysler Aspen 2008-2009/Dodge Durango 2008-2009 ..... 1
- Chrysler Sebring 2007-2009 ..... 2
- Chrysler Town and Country 2008-2009 ..... 3,4
- Chrysler 300/300C 2008-2009 ..... 5
- Dodge Avenger 2007-2009 ..... 6
- Dodge Caliber 2009 ..... 12
- Dodge Challenger 2009 ..... 12
- Dodge Dakota 2008-2009 ..... 7
- Dodge Grand Caravan 2008-2009 ..... 3,4
- Dodge Magnum/Charger 2008 ..... 5
- Dodge Nitro 2007-2009/Liberty 2008-2009 ..... 8
- Dodge Journey 2009 (Modifications to radio cavity required) ..... 9
- Dodge Ram 1500 2009 ..... 13,14
- Jeep Commander/Grand Cherokee 2008-2009 ..... 10
- Jeep Compass 2009 ..... 12
- Jeep Patriot 2009 ..... 12
- Jeep Wrangler 2007-2009 (Modifications to radio cavity required) ... 11
- Mitsubishi Raider 2008 ..... 7

### Kit Assembly

- Double DIN Radio Provision ..... 15
- Stacked ISO Units Provision ..... 15

**Final Assembly ..... 16**

**\*Note:**

**Refer also to the instructions included with the aftermarket radio.**



### **KNOWLEDGE IS POWER**

Enhance your installation and fabrication skills by enrolling in the most recognized and respected mobile electronics school in our industry. Log onto [www.installerinstitute.com](http://www.installerinstitute.com) or call 800-354-6782 for more information and take steps toward a better tomorrow.

**CHRYSLER ASPEN 2008-2009**  
**DODGE DURANGO 2008-2009**

- 1** Disconnect the negative battery terminal to prevent an accidental short circuit.
- 2** Unsnap and remove storage cup holder assembly. (Figure A)
- 3** Remove (2) screws from bottom edge of center dash trim panel. Unsnap and remove the panel. (Figure B)
- 4** Remove (4) screws securing the radio. Unplug and remove radio. (Figure C)

*Continue to kit assembly.*

**A**

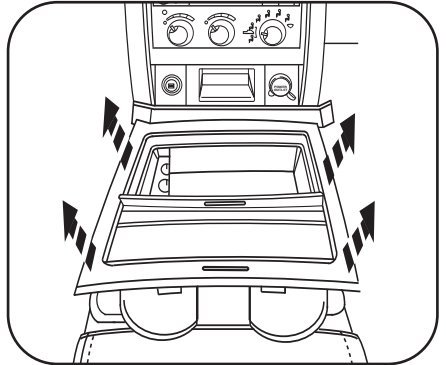

**B**

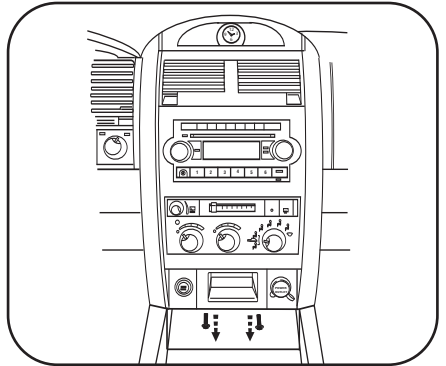

**C**

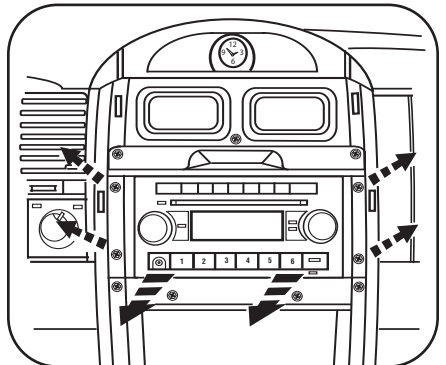

## **CHRYSLER SEBRING 2007-2009**

- 1** Disconnect the negative battery terminal to prevent an accidental short circuit.
- 2** Unclip entire panel surrounding radio including a/c vents and clock. Unplug and remove panel. (Figure A)
- 3** Remove (4) 7MM screws securing radio. Unplug and remove radio. (Figure B)

*Continue to kit assembly.*

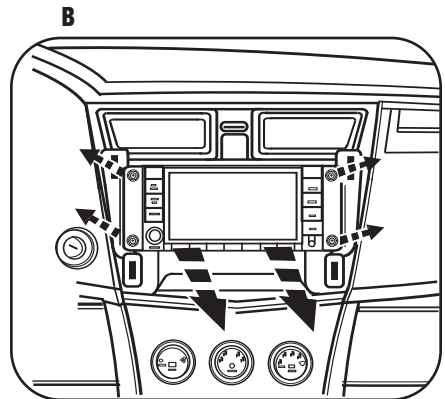
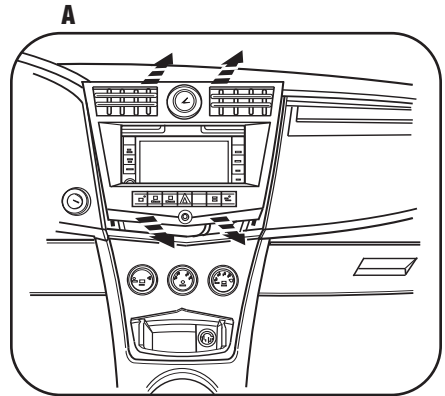

**CHRYSLER TOWN AND COUNTRY 2008-2009  
DODGE GRAND CARAVAN 2008-2009**

- 1 Disconnect the negative battery terminal to prevent an accidental short circuit.
- 2 Remove (2) screw covers facing up above radio then remove the (2) Phillips screws exposed. (Figure A)
- 3 Lift up on panel above radio then remove (2) Phillips screws exposed at front edge of radio trim panel. (Figure B)
- 4 Remove (3) plastic push pins per side of bottom trim panel then slide panel toward rear of van to access (2) screws on bottom of radio trim panel. (Figure C)

*Continued on page 3.*

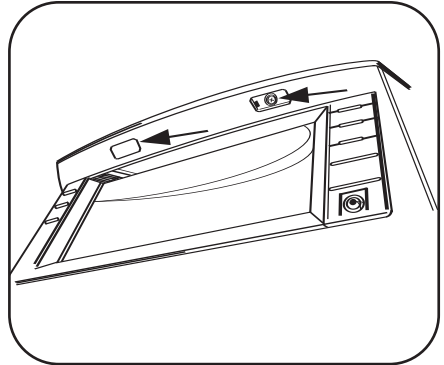
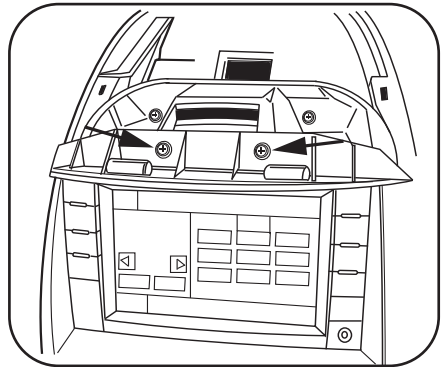
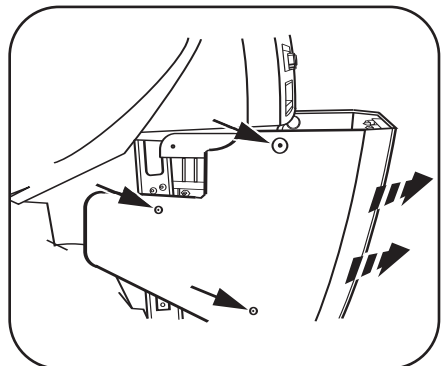
**A****B****C**

**CHRYSLER TOWN AND COUNTRY 2008-2009**  
**DODGE GRAND CARAVAN 2008-2009**

- 5** Remove (2) Phillips screws exposed at bottom edge radio trim panel. (Figure D)
- 6** Unclip and remove entire panel surrounding radio including climate controls, vents and clock. (Figure E)
- 7** Remove (4) Phillips screws securing radio. (Figure F)

*Continue to kit assembly.*

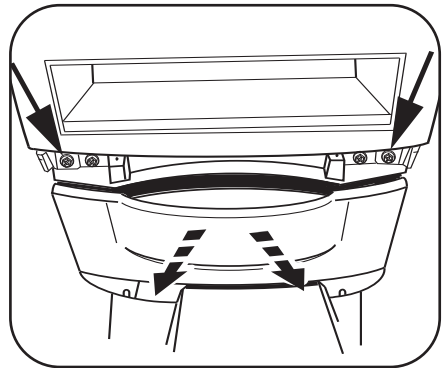
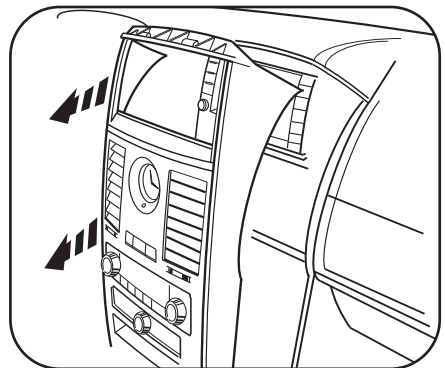
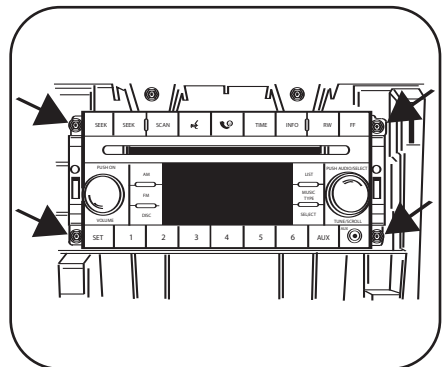
**D**

**E**

**F**

## **CHRYSLER 300/300C 2008-2009** **DODGE MAGNUM/CHARGER 2008**

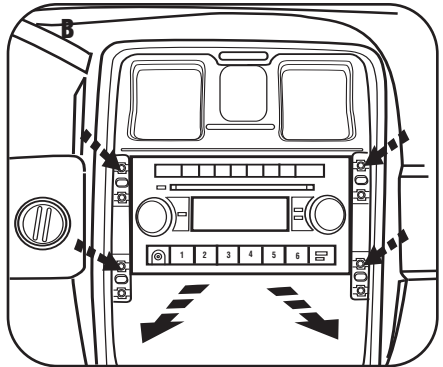
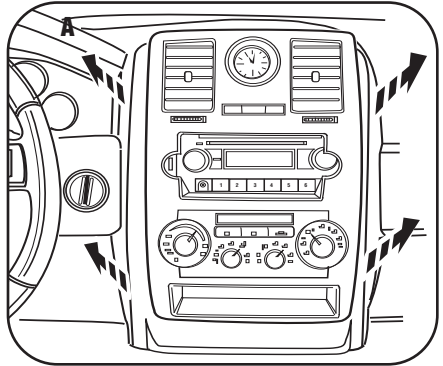
- 1** Disconnect the negative battery terminal to prevent an accidental short circuit.
- 2** Unsnap and remove center dash trim panel. (Figure A)
- 3** Remove (4) screws securing the radio. Disconnect and remove the radio. (Figure B)

*Continue to kit assembly.*



## DODGE AVENGER 2007-2009

- 1** Disconnect the negative battery terminal to prevent an accidental short circuit.
- 2** Unclip and remove the center console trim panel. (Figure A)
- 3** Unclip the center dash trim panel. (Figure B)
- 4** Remove (4) screws securing the radio. Disconnect and remove the radio. (Figure C)
- 5** Remove (3) screws securing the radio rear support bracket and remove the bracket. (Figure D)

*Continue to kit assembly.*

**A**

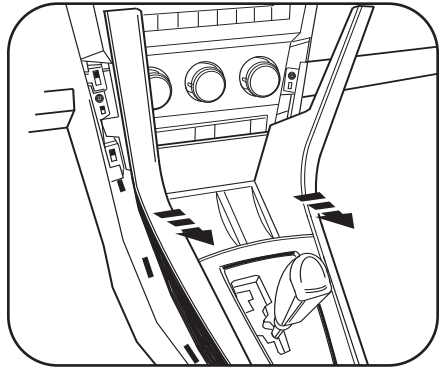

**B**

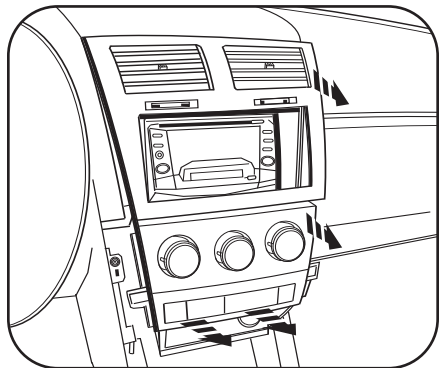

**D**

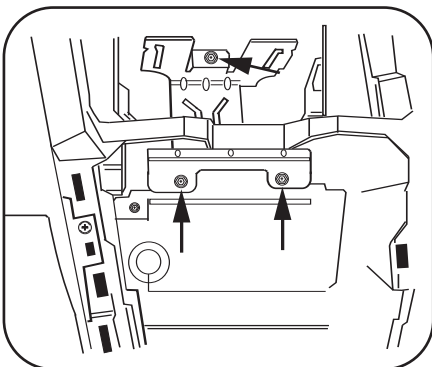

**C**

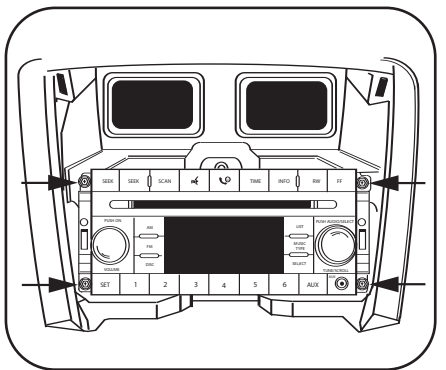



## DODGE DAKOTA 2008-2009

- 1 Disconnect the negative battery terminal to prevent an accidental short circuit.
- 2 Unclip and remove the trim panel surrounding the radio. (Figure A)
- 3 Remove (4) Phillips screws securing the radio. (Figure B)

*Continue to kit assembly.*

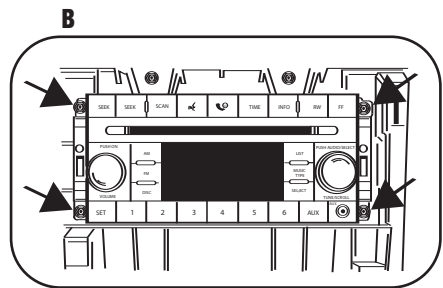
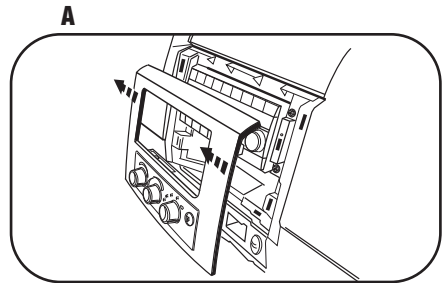



---

## MITSUBISHI RAIDER 2008

- 1 Disconnect the negative battery terminal to prevent an accidental short circuit.
- 2 Unsnap and remove center dash panel. (Figure A)
- 3 Remove (4) 7mm screws securing the radio. Unplug and remove radio.

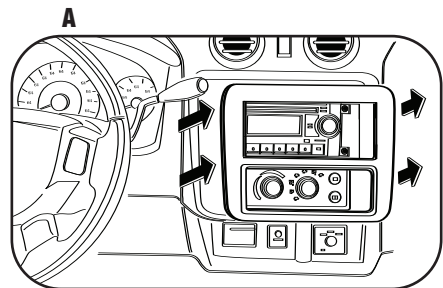
*Continue to kit assembly.*



**DODGE NITRO 2007-2009**  
**JEEP LIBERTY 2008-2009**

- 1** Disconnect the negative battery terminal to prevent an accidental short circuit.
  
- 2** Unclip entire panel surrounding radio and climate controls, including a/c vents. Unplug and remove panel. (Figure A)
  
- 3** Remove (4) 7MM screws securing radio. Unplug and remove radio. (Figure B)

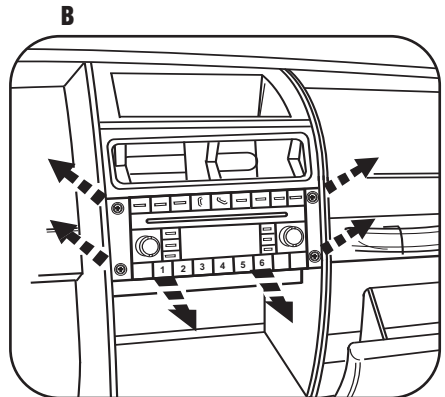
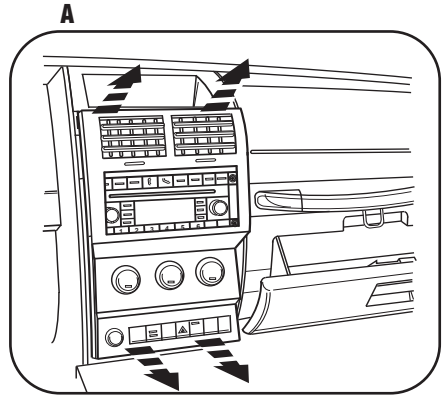

*Continue to kit assembly.*

## **DODGE JOURNEY 2009**

**1** Disconnect the negative battery terminal to prevent an accidental short circuit.

**2** Unclip and remove the entire factory radio trim panel including the a/c controls. (Figure A)

**TIP:** *Open the compartment door at the top of the radio trim panel.*

**3** Remove (4) 7MM screws securing radio to dash to remove. (Figure B)

**NOTE:** *The top of the metal bracket in the sub dash will need to be cut to allow for the clearance of the Double DIN radio's chassis. (Figure C)*

*Continue to kit assembly.*

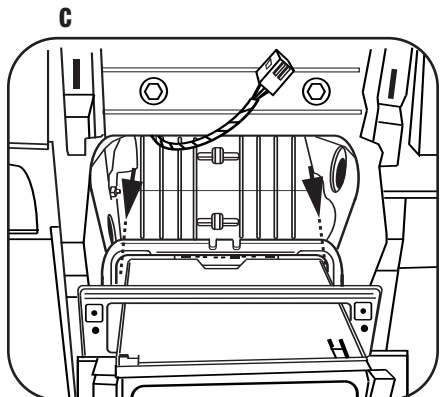
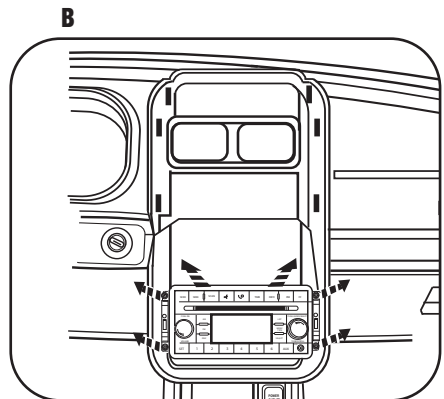
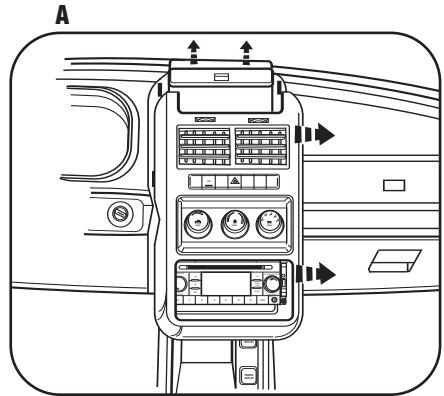

**JEEP COMMANDER/GRAND CHEROKEE 2008-2009**

- 1** Disconnect the negative battery terminal to prevent an accidental short circuit.
- 2** Unsnap and remove the small trim around the console shifter. (Figure A)
- 3** Unsnap and remove the larger trim around the console shifter. (Figure B)
- 4** Remove one Phillips screw from inside the small storage pocket in the lower dash, between the power outlets. (Figure C)
- 5** Unsnap and remove the dash panel from around the radio (including climate controls). (Figure D)
- 6** Remove (4) Phillips screws securing the radio. Unplug and remove radio.

*Continue to kit assembly.*

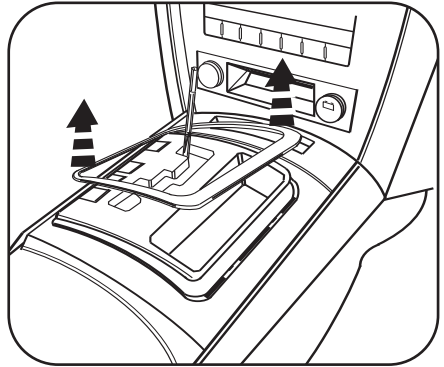
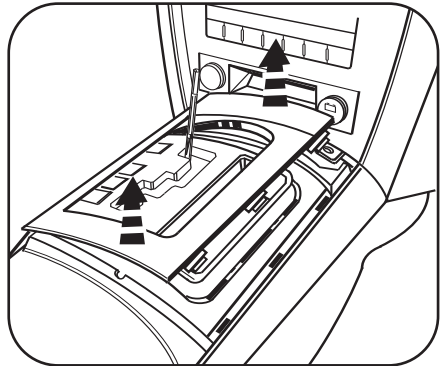
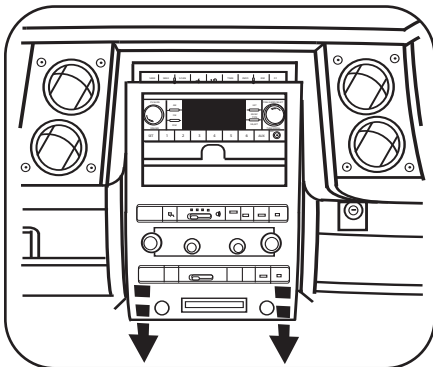
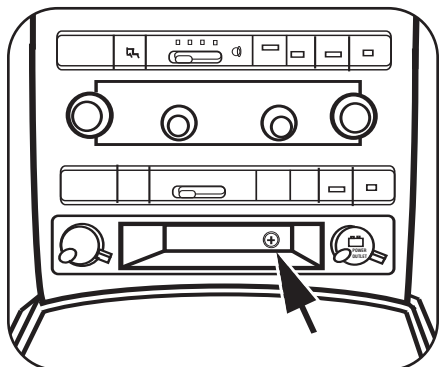
**A**

**B**

**D**

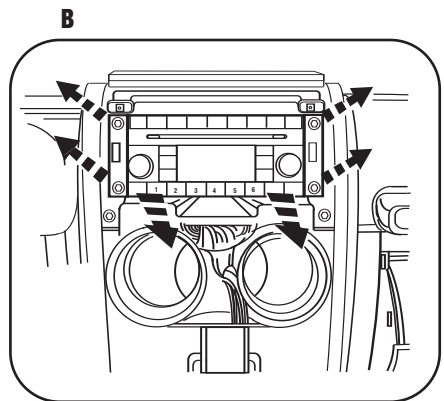
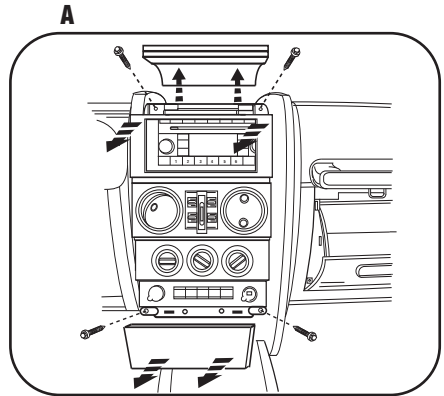
**C**

## JEEP WRANGLER 2007-2009

- 1 Disconnect the negative battery terminal to prevent an accidental short circuit.
- 2 Unclip and remove the lower center trim below a/c controls. (Figure A)
- 3 Remove (2) Phillips screws exposed behind lower center panel. (Figure A)
- 4 Unclip and remove the upper center trim starting towards the rear of the panel. (Figure A)
- 5 Remove (2) Phillips screws exposed behind upper center panel. (Figure A)
- 6 Unclip and remove entire panel surrounding radio and climate controls, including a/c vents.
- 7 Remove (4) 7MM screws securing radio. Unplug and remove radio. (Figure B)



**NOTE:** *The top of the metal bracket in the sub dash will need to be cut to allow for the clearance of the Double DIN radio's chassis.*

*Continue to kit assembly.*

**DODGE CALIBER 2009**  
**DODGE CHALLENGER 2009**  
**JEEP COMPASS 2009**  
**JEEP PATRIOT 2009**

- 1** Disconnect the negative battery terminal to prevent an accidental short circuit.
- 2** Unsnap and move shifter trim to the side. **(Figure A)**
- 3** Unsnap center dash trim panel (do not remove until climate controls are removed). **(Figure A)**
- 4** Remove (4) Phillips screws holding climate control panel to backside of the center dash panel.
- 5** Remove (4) 7MM screws securing radio. Unplug and remove radio.
- 6** The metal bracket in the sub-dash will need to be removed for the aftermarket Double DIN radio's depth.

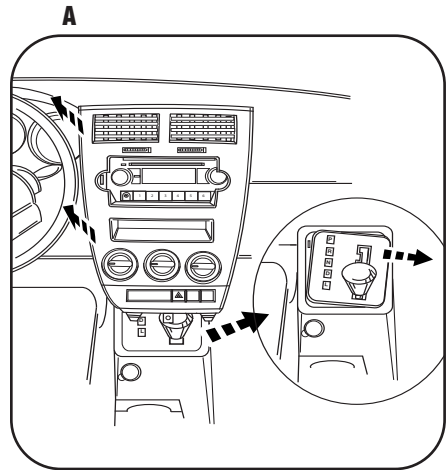

*Continue to kit assembly.*

## **DODGE RAM 1500 2009**

- 1** Disconnect the negative battery terminal to prevent an accidental short circuit.
- 2** Remove (1) T25 Torx screw in the compartment next to the cup holders. (**Figure A**)
- 3** Remove (2) Phillips screws in the pocket below the climate control in the front of the center console. (**Figure B**)
- 4** Remove (2) 9/32" screws in the cup holders. (**Figure C**)
- 5** Push down on the collar below the shifter then pull the shifter straight up to remove. (**Figure D**)
- 6** Unclip and remove the top of the center console including the cup holders. (**Figure E**)

*Continued on page 14.*

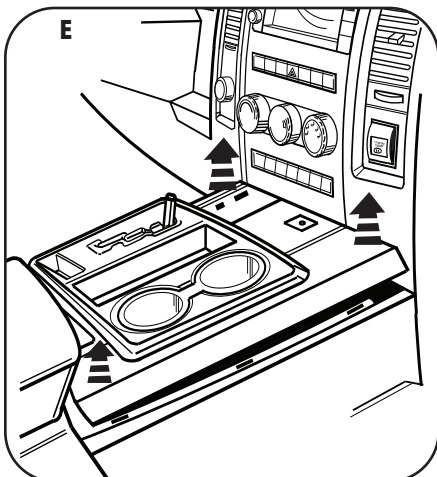
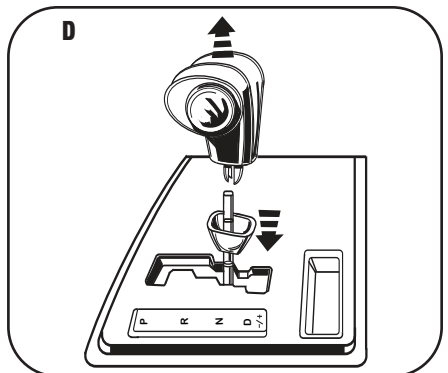
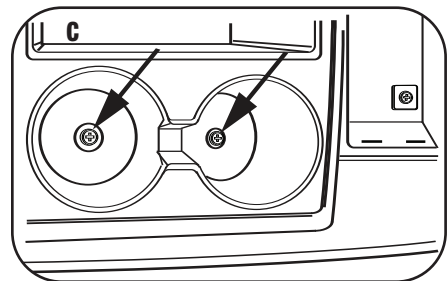
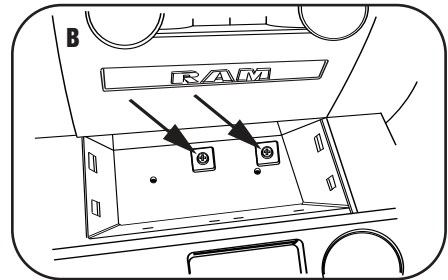
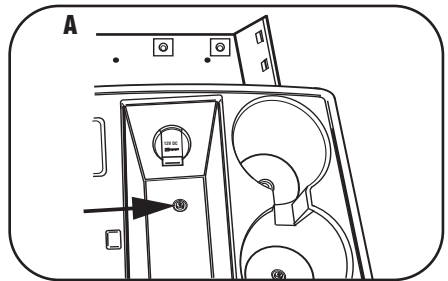

**DODGE RAM 1500 2009**

- 7** Unclip and remove the trim panel from the accessory socket on the radio trim panel, then remove (1) T25 Torx screw. **(Figure F)**
- 8** Remove (2) T25 Torx screws from the top of the radio trim panel. **(Figure G)**
- 9** Unclip and remove the entire radio trim panel including the climate controls. **(Figure H)**
- 10** Remove (4) 9/32" screws securing the radio. **(Figure I)**

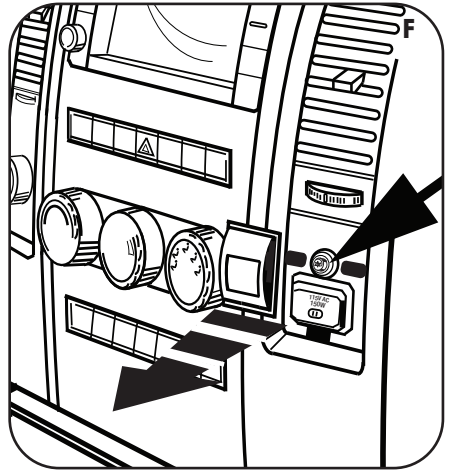

*Continue to kit assembly.*

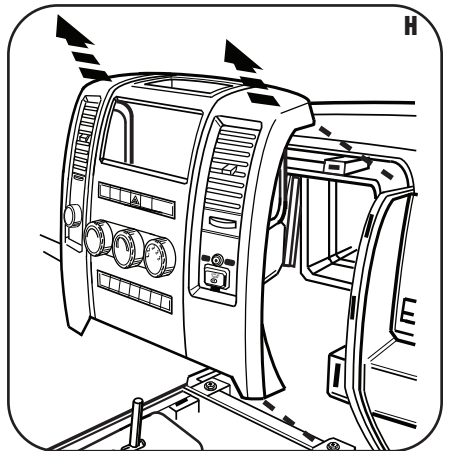
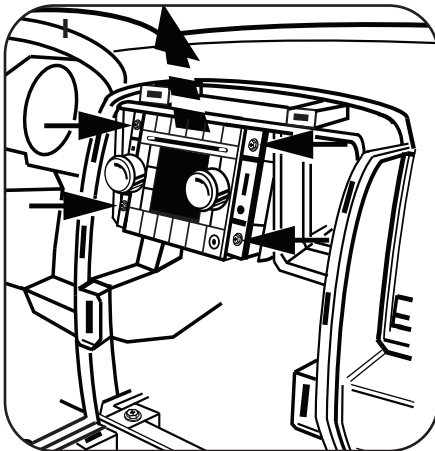
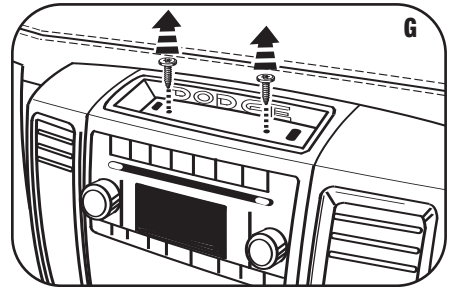



## DOUBLE DIN RADIO PROVISION

*\*Note: Refer also to the instructions included with the aftermarket radio.*

- 1 Attach the Double DIN brackets/trim plates to the Double DIN Radio using the screws supplied with the Radio. (Figure A)

*Continue to final assembly.*

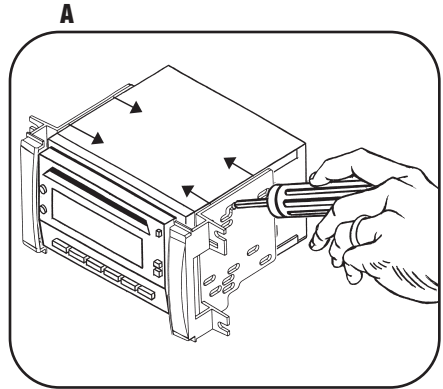

## STACKED ISO UNITS PROVISION

*\*Note: Refer also to the instructions included with the aftermarket radio.*

- 1 Attach the Double DIN brackets/trim plates to the stacked ISO units using the screws supplied with the units. (Figure A)

*Continue to final assembly.*

